

SANSHO HOUSE

Usage Details

Groups of 10 or more: Accepted year-round
Individuals under 10: Available dates change annually.
Please check the website's reservation page.



Sansho House Facility Information

The nostalgic wooden schoolhouse was built in 1958, and after more than 70 years, it still withstands heavy snowfall and is carefully protected by people. Sansho House serves as a base facility for the Echigo-Tsumari Art Triennale and is open to many visitors, including individuals, families, and the Kohebi-tai, a group of supporters of the Art Triennale. Visitors can also view the works of world-renowned artist Leandro Erlich. With the addition of local residents, Sansho House looks forward to welcoming you. In winter, we also offer organized tours to coincide with local small New Year's events.

- The building is about 70-year-old wooden structure. We ask for your understanding in operating a facility built in a village.
- **There is no air conditioning in the guest rooms. There are fans and simple cooling fans in the summer and heaters in the winter, but please be aware that it can get hot, especially in the summer.**

Sansho House Facility Information

Lodging and Exchange Building: 2-story wooden structure, 955 sq.m.

Rooms: 6 total (4 rooms for 16 persons, 2 rooms for 8 persons)

Capacity: 80 people
Gymnasium: Steel construction, 652 square meters

Bathrooms: Separate for men and women, showers only

Toilet: Separate for men and women, 1F (2 places), 2F (1 place)

Washing machines and dryers: 2 each (free of charge)

Other: Valuables lockers (free of charge)

Parking: Free 30 spaces in total

Sansho House Facility Information

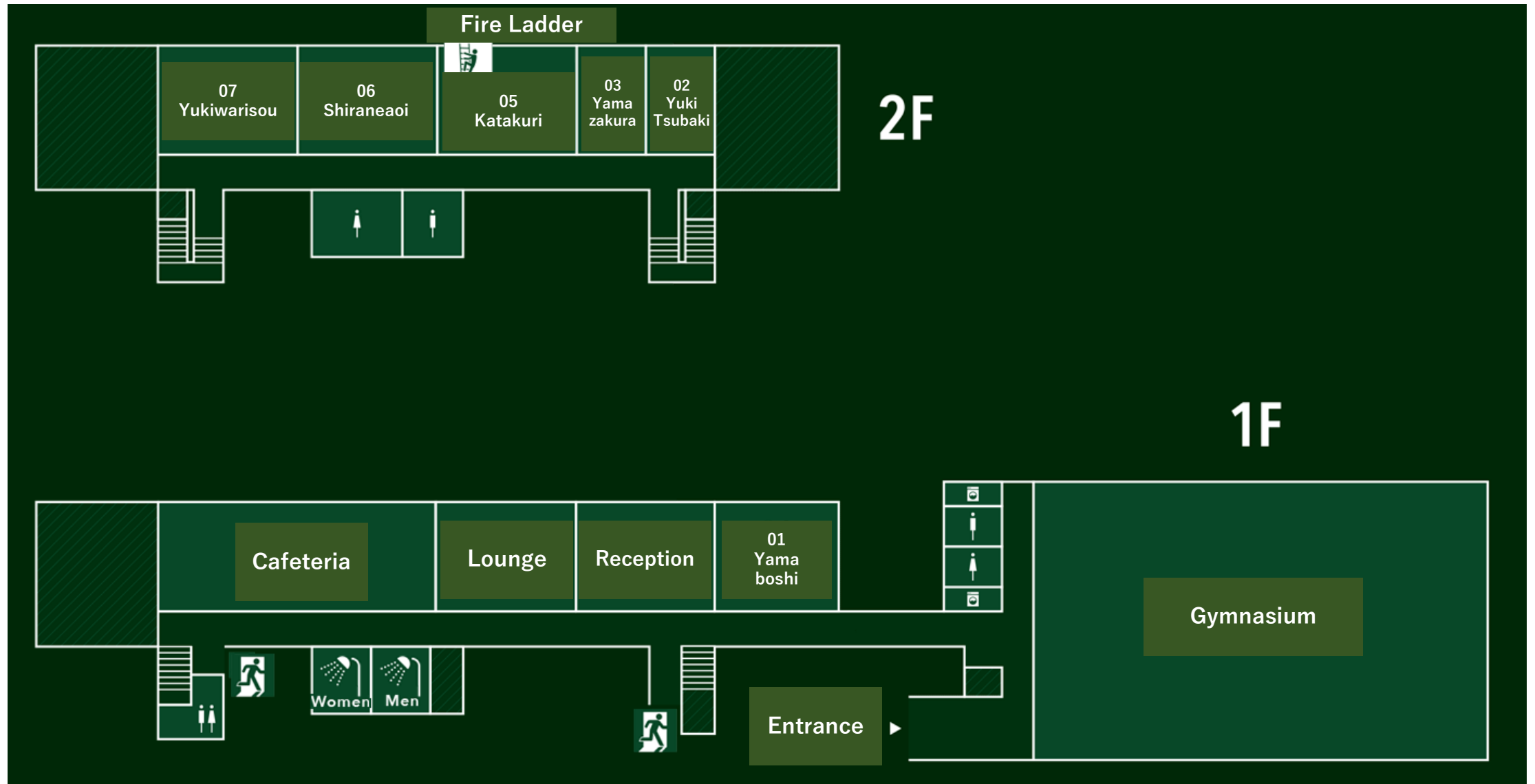

Facility Information

Guest room

Sansho House can accommodate 80 people in six rooms, four for 16 people and two for 8 people, in rooms that were once classrooms.

Rooms are furnished with bunk beds, and men and women sleep in separate rooms.

Please note that there are no private rooms.

- Beds in the rooms are separated by curtains. Please note that you may be placed in the same room with another group. Please help yourself to set up your bed sheets.



Cafeteria

The cafeteria is a spacious area where guests can gather together by removing the partition between the two classrooms. In addition to meals, the dining room can be used for workshops, meetings, and other purposes. It is also a great place to spend time according to the season. Enjoy the refreshing outdoor terrace during the summer season.

- Please use the cafeteria space for food and drink.

- **You are not allowed to bring in alcoholic beverages.**

You can buy alcoholic beverages in a cafeteria. Only cash is accepted.

Price: canned beer 300 yen / one cup of sake 300 yen / canned chuhai 200 yen



Gymnasium/Grounds

We have a gymnasium that can be used for seminars, exercise, and other multi-purpose activities. The gymnasium is equipped with a badminton set, balls, and other simple equipment, so you can play freely during your stay. In winter, the ground is covered with snow, so you can play in the snow to your heart's content.

Shower room

We recommend using a nearby day-trip bathing facility (about 10 minutes by car) for bathing. In Sansho House, only showers are available.

***We do not provide transportation service to and from the hot spring facilities.**



Usage Fees

Accommodation Fee

Prices include tax. Check-in time is from 4:00 p.m. on the day of your stay and check-out time is by 10:00 a.m. the next day.

Children under elementary school age may share a bed with a parent or guardian (sleeping with a parent).

No overnight stay fee will be charged for those who sleep with their parents.

However, an additional 500 yen will be charged on the day before weekends and holidays.

Cancellation Policy

The percentage is the ratio of the penalty charge to the basic rate.

If the contracted number of days is shortened, the penalty fee for the first day will be collected regardless of the number of days shortened.

	Adults (Junior high school students and above)	elementary school student	Less than elementary school age
1 night, 2 meals ※ Plus 500 yen in the day before Saturdays, Sundays and holidays	6,750 yen	4,750 yen	4,000 yen ※ In case of bed use and 2 meals
Staying overnight without meals	4,000 yen	3,000 yen	Bed use → 3,000 yen Sleeping together → free
Dinner	1,870 yen	1,000 yen	600 yen
Breakfast	880 yen	750 yen	400 yen

Not staying	On the day	One day before	2 to 5 days before
100%	100%	50%	30%

Echigo-Tsumari Art Triennale Artworks

Leandro Erlich “Lost Winter”

The Sansho House has a permanent installation of works from the Echigo-Tsumari Art Triennial.

Leandro Erlich's “Lost Winter”.

From a door in one of the exhibition rooms, an early spring view of Matsunoyama. Snowdrops peek out from the snow, and in the evening you can hear the sound of frogs. While snow still remains, this work imagines a landscape that rejoices in the small signs of spring after a long, long winter. *

*** “Lost Winter” is currently only available for viewing, and no evening programs are available.**

Artworks in the museum open to the public during your stay

Y122

Murayama Goro

「Generating drawings -from wild birds in Matsunoyama」 2024

Y045

Aigars Bikše

「Good Things from Latvia for Good People in Faraway Japan」 2006

Y027

Linda Covit

「Storehouse of Names」 2003



Facility Hours and Notes

Facility Hours

Check-in: 16:00~/ Check-out: ~10:00

Dinner time: 19:00~21:00 / Breakfast time: 7:00~9:00

Curfew: 22:00/ Lights out 23:00

Cafeteria use time:~22:30/ Alcohol sales:~22:00

Gymnasium, gallery, store, laundry use time:
~21:00/6:30~9:30

Shower hours: ~22:00/6:30~9:00

- We recommend using a nearby day-trip bathing facility for bathing.

*We do not provide transportation service to and from the hot spring facilities.

Requests for use

- For payment of the fee, we ask that you make payment in advance at the reservation site.
- Everything in Sansho House is self-service. Please help yourself to change bed sheets, serve and remove meals, etc.
- Please understand that during the Echigo-Tsumari Art Triennale, the contents of the website may differ slightly due to the use of the website by festival personnel and supporters.
- Please take care of your valuables on your own (lockers for valuables are available on the 1st floor).
- Smoking is not permitted in the entire building. Please smoke in the smoking area.

Access

By Car

By car (from April to November) Tokyo (about 3 hours) - Kanetsu Expressway Shiozawa Ishiuchi IC - Route 353 - Kan-etsu Expressway Muikamachi IC - Route 253 Nagoya (about 4 hours) - Chuo Expressway - Nagano Expressway - Joshinetsu Expressway Toyota Iiyama IC - Route 117 Kanazawa (about 3 hours and 30 minutes) - Hokuriku Expressway Joetsu IC - Route 253 Niigata (about 2 hours) - Kan-etsu Expressway Echigo-Kawaguchi IC - Route 117 Kansai area (about 6 hours) - Meishin Expressway - Hokuriku Expressway Joetsu IC - Route 253

By train

Train Approximately 2.5 hours from Tokyo and Niigata. Take the Shinkansen / Hokuhoku line to Echigo-Yuzawa to Matsudai. To reach Sansho House, take a local bus or cab.

■ Taxi (Tobu Taxi) TEL/025-597-2254

Please note that cabs are not open after 6:00 p.m.

■ Bus Please note that there are not many buses available. The closest bus stop to Sansho House is 「Kotani」. Please refer to the excerpt of the bus timetable on the right. Large buses are not allowed in the village.

(Medium-sized buses can enter and exit the back of the facility from April to November except during the snow season. If you are coming by large buses, please contact the above.)

By local bus

Please use the following when taking the bus to Sansho House.

The nearest bus stop to Sansho House is “Kotani”.

Tokamachi Line To Sansho House

Tokamachi → Matsudai → Matsunoyama Onsen Matsudai Ekimae - Kotani 15:22→15:35/18:05→18:18

Departing from Sansho House

Matsunoyama Onsen → Matsudai → Tokamachi

Kotani - in front of Matsudai Ekimae

*7:18→*7:31/8:13→8:26/10:13→10:26

The * mark is out of service on Saturdays, Sundays, national holidays and during 8/15, 16, and 12/31 - 1/3.

Winter Season Usage Information

○December–April

During December to April, when individual reservations are not accepted, we accept reservations for groups of 10 or more.

○Transportation

Please be aware that during the snow season, access by private vehicle is generally not permitted. Please understand that roads within the village are narrow, making parking difficult. If you wish to visit by private vehicle, a four-wheel drive vehicle equipped with studless tires is mandatory. Please contact the front desk in advance before visiting.

○Heating

Equipment Kamaras and dining rooms are heated by kerosene stoves, and electric blankets are provided for each bed. Additionally, a wood-burning stove is used in the dining room. However, hallways, staircases, and the entrance area are not heated. Please wear warm clothing even indoors.



Inquiries

Location: 326 – 2Kotani, Matsunoyama, Tokamachi-shi, Niigata 942-1402

Inquiry: info@sanshohouse.jp

TEL:025-596-3854 (In case of absence, the call will be forwarded to the following number)

TEL:025-761-7767 (Echigo-Tsumari Art Field General Information Center)

Sansho House Facilities Information

<https://www.echigo-tsumari.jp/travelinformation/sanshohouse/>

Sansho House Reservation URL

<https://echigo-tsumari.urkt.in/ja/direct/offices/3009/courses>

Parking lot in the village

Around the village

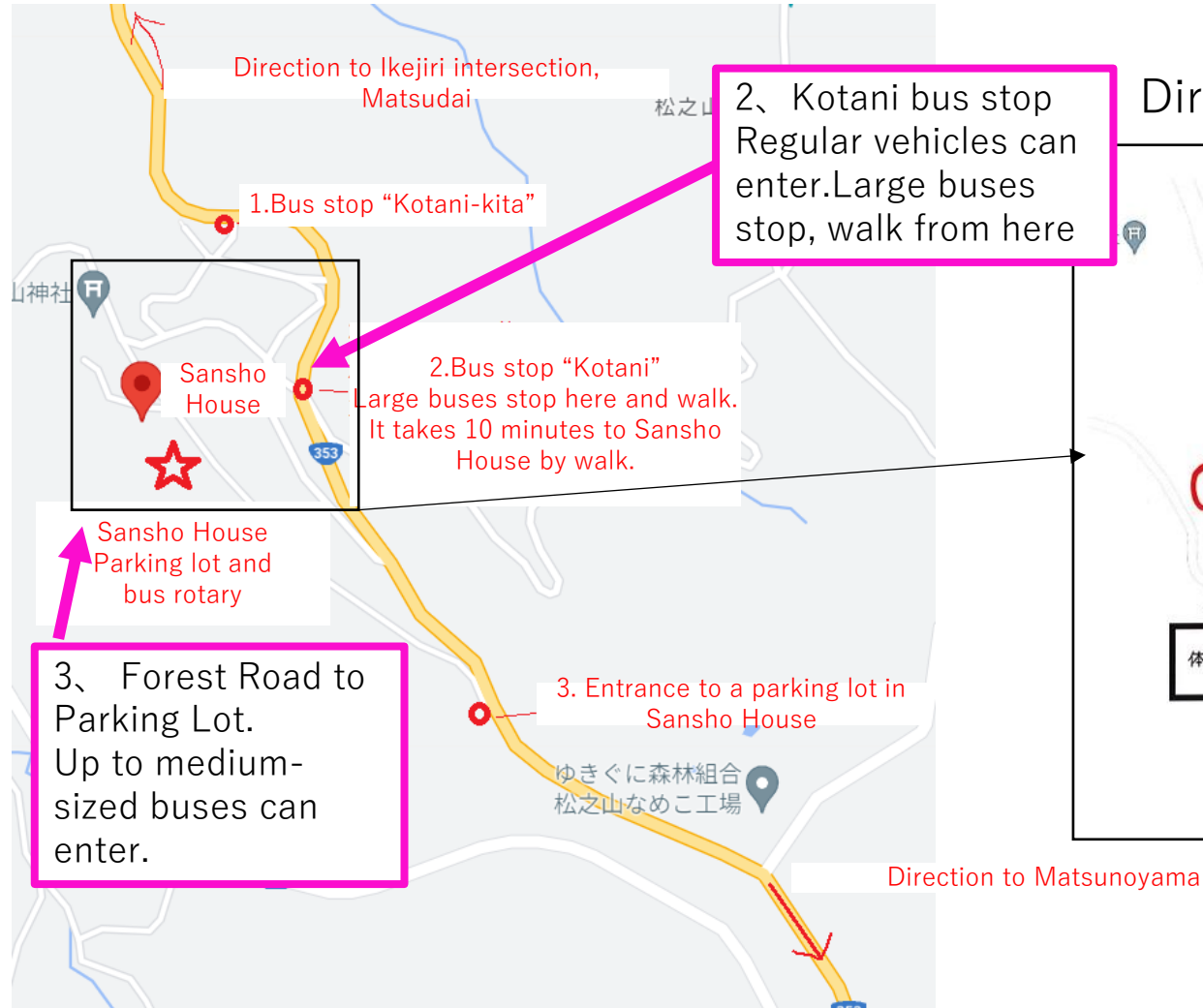

Direction to Sansho House

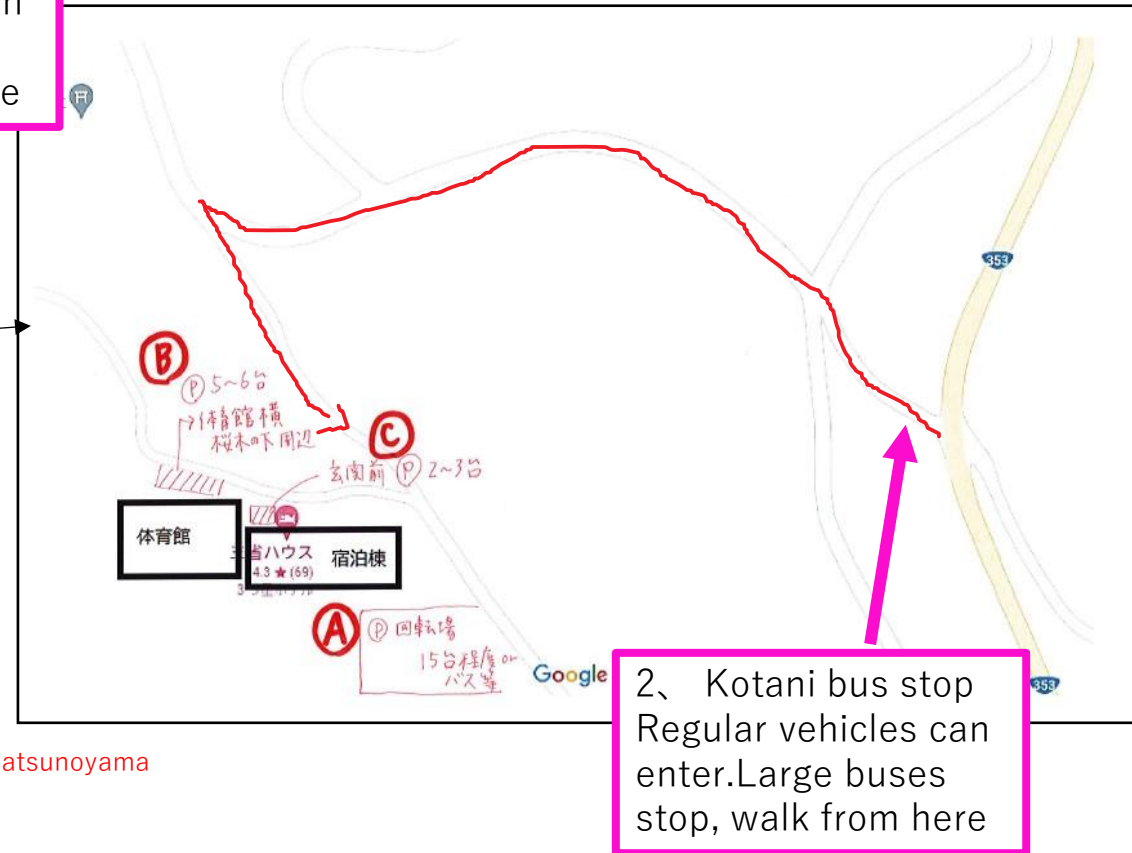

Parking lot in the village

By regular car

You can enter the village by private car from 2 and 3. You may use B and C for unloading, but please use A for parking.

Up to medium-sized buses

The village can be accessed from 3. Please let us know if you are entering the village because there may be parking in some cases.

Large buses

You are not allowed to enter the village. 2. Please stop at the Kotani bus stop (private house) and go up on foot. Please let us know when you arrive so that we can contact people who live around the facility.

