

① Unoccupied shops in the Tokamachi-city centre

Images



Past artworks



IKEDA Mitsuhiro, "by the Window Tokamachi Version" (2003)
photo by ANZA ĩ



HISHIYAMA Yuko, "A BIG GUY" (2003)
photo by ANZA ĩ



me, "Completed Conjecture" (2015)
photo by ISHIZUKA Gentaro

① Unoccupied shops in the Tokamachi-city centre

The area spreading from the east exit of Tokamachi station is the centre of Tokamachi-city. It was once a bustling shopping district with lots of weavers dotted around and their employees during the peak of silk industry prosperity. However, more and more shops have become unoccupied due to the decline of the industry and ageing of the residents.

In the previous iteration of ETAT, we held “Hojoki Shiki Village:100 years initiative”, a prototype exhibition consisted of unique and diverse worlds operated in a small space as an attempt to envision the future of this city centre. While we are unable to specify which of the unoccupied shops would be available for the open call proposals, we welcome unique ideas that will facilitate collaboration with residents and shop owners and attract many visitors.

Images



Past artworks



Satoyama Art Zoo (2018)
photo by NAKAMURA Osamu



SHIOZAWA Hironobu, "We are all friends"



SUSAMI Aya, "I don't wanna think anything"

② Nakago Green Park

Blueprint

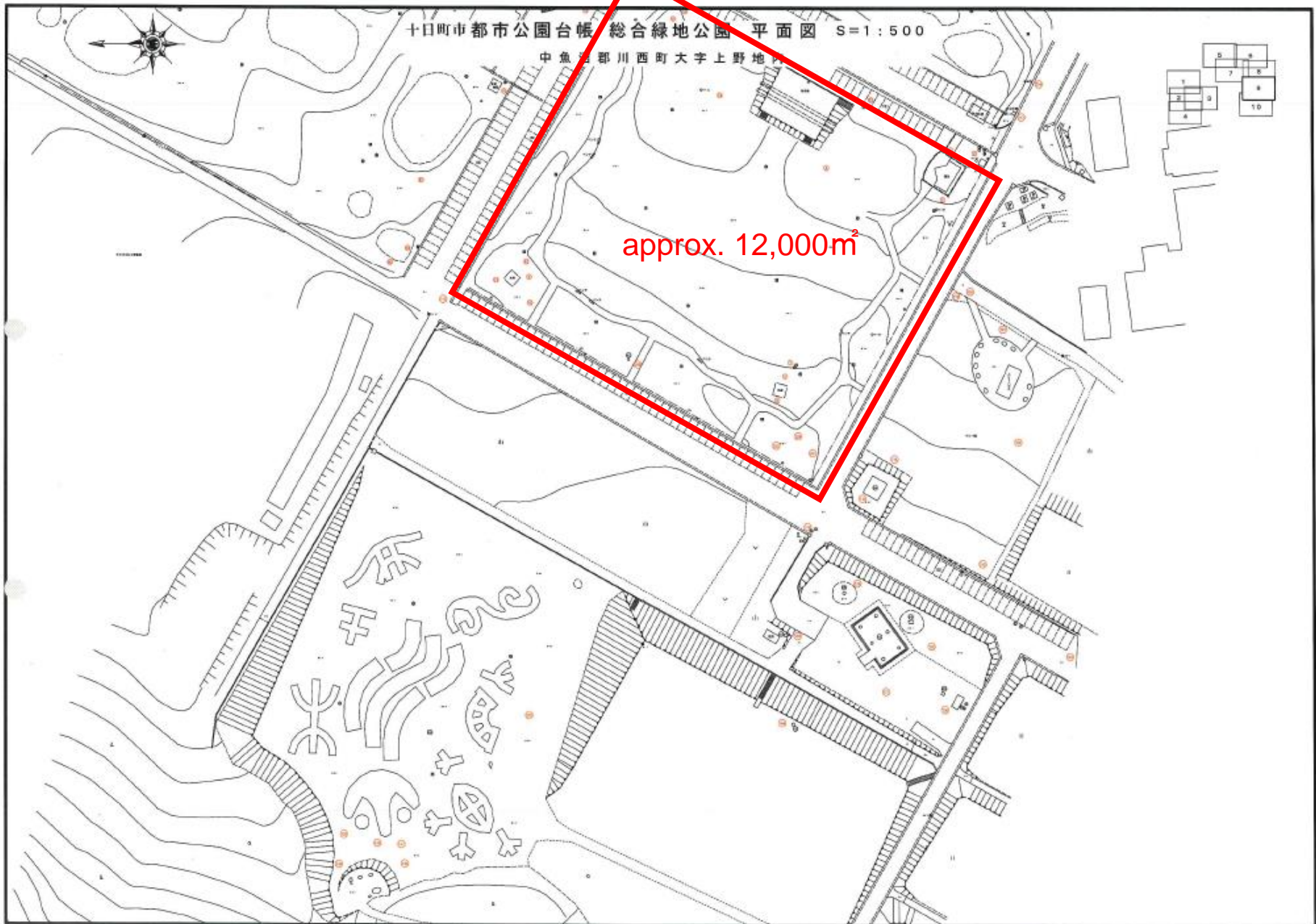

Nakago Green Park is an extensive city park located in the centre of Kawanishi area. In addition to lots of artworks dotted around in the area such as “House of Light” by James Turrell, there are putter golf course and a rest house and Fushikurojo-ato camping ground at the back, all of which constitute a place for local people to enjoy their leisure time with their families.

In the last ETAT, the park hosted “Satoyama Art Zoo” with about 30 artists and groups presented their works which made it a popular place for adults and children to enjoy. We look forward to receiving plans which will make the best use of the vast green environment which is rare for Echigo-Tsumari.

③Front garden at Katakuri House

Images(363m²)



1:700集成図

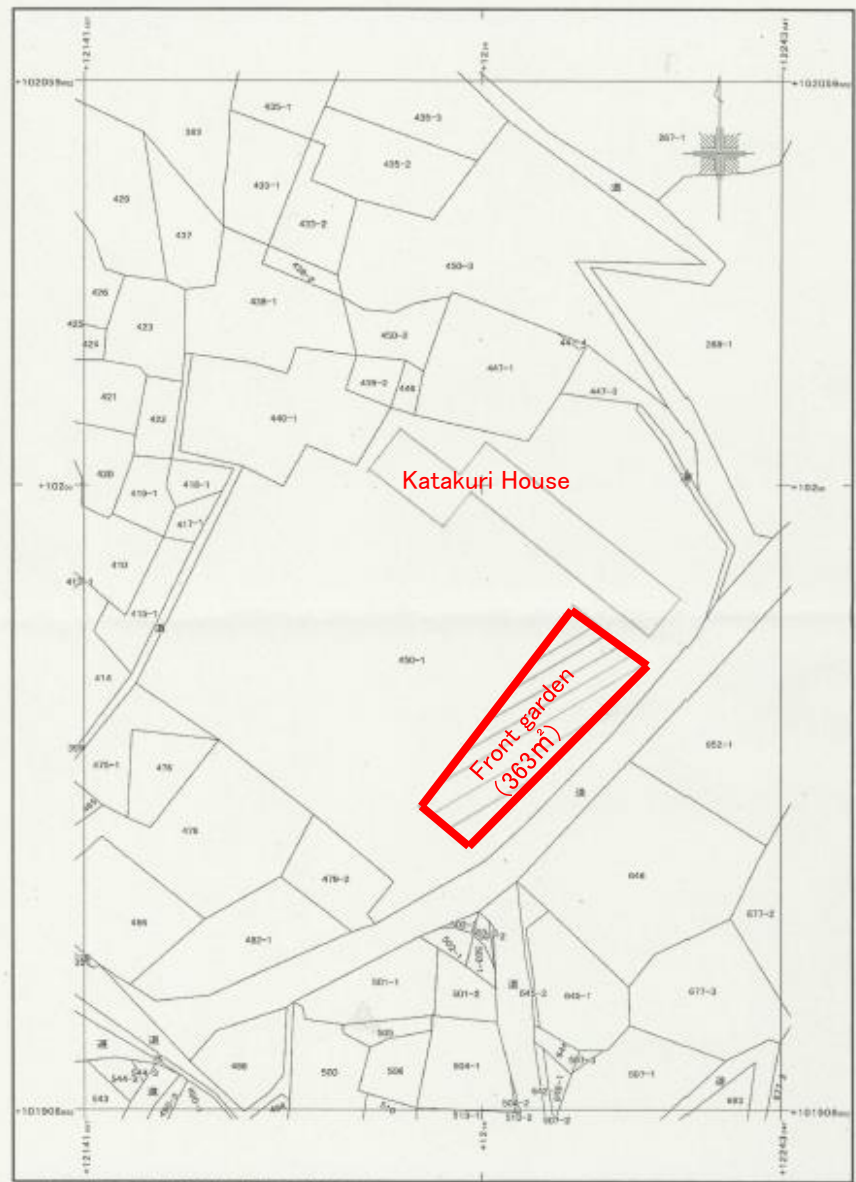

※この図面の座標値は法的な拘束力がありません。

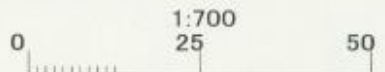

斜線部分 駐車場
1cm 7m

③Front garden at Katakuri House

Katakuri House is a closed school in Akiyama-go which was rebuilt and repurposed as an accommodation in 1992. Located at the midpoint of Akiyama-go, an unexplored area in Echigo-Tsumari known for continuous steep but beautiful landscape at the southern tip of Tsunan Town in Niigata Prefecture close to the border to Nagano Prefecture, Katakuri House has been a favourite place to stay at for those who admire this area.

While it is approximately one hour drive away from the centre of the festival, this is an important place for Echigo-Tsumari. Villages scattered in the mountains and life in those villages deeply closed in winter due to the heavy snowfall strongly retain what Satoyama is – the backbone of ETAT. It can also be described as a place which represents the world of “Hokuetsu Seppu” by SUZUKI Bokushi, a reference frequently made to various programs of ETAT. We seek for plans of artworks that will take into consideration of these background.

④Swimming pool at Yukihiisa Isobe Memorial Echigo-Tsumari Kiyotsu SOko Museum of Art

Images (25m × 3 Lanes)



Yukihiisa Isobe Memorial Echigo-Tsumari Kiyotsu Soko Museum of Art is a museum born from the renovation of a school building and gymnasium of the former Kiyotsukyo Elementary School. While it houses the collections of work by ISOBE Yukihiisa, one of the representing artists of ETAT, it has been exploring an alternative role of a regional art museum through its unique operation which combines both presenting and storing artworks.

The Kiyotsukawa river running along the museum is a tributary of the Shinanogawa river and is known for its beautiful stream that local people are proud of. After the artwork in the Kiyotsukyo Keikoku Tunnel by Ma Yansong and MAD Architect was launched, this area became most popular place to visit in ETAT. By transforming the swimming pool directly connected to the gymnasium space of the museum, we wish to further enhance the attractiveness of the place.

⑤ Play equipment at Matsudai Snow-Land Agrarian Culture Center, Matsudai (Matsudai Nohbutai)

Images



Past artworks



ZEROZEROESUESU, "Go to SUKIMA" (2006)



USHIJIMA Hitoshi, "Jungle Gym on wheels" (2006)



IWAI Akiko + OBA Yoko, "sound park", (2009) photo by NOGAWA Kasane

⑤ Play equipment at Matsudai Snow-Land Agrarian Culture Center, Matsudai (Matsudai Nohbutai)

Matsudai Nohbutai is one of the hub facilities of ETAT where masterpieces including “The Rice Field” by Ilya and Emilia Kabakov and “Tsumari in Bloom” by Yayoi Kusama are concentrated. Joyama area adjacent to Matsudai Nohbutai hosts farming activities and nature observation workshops amongst lots of artworks outdoor. There is a plan to develop this area into a tourist farm in not too distant future where families can spend a day and fully appreciate the region which has been growing with agriculture.

For long time, there have been unique artworks created and renewed as play equipment on at the piloti and surrounding space of Matsudai Nohbutai. We look for proposals for play equipment that will be specifically made for this place.

⑥ Classroom at NUNAGAWA Campus

Appearance



Past artworks



Dian, "Mottainai"(2019 summer program), Photo by NAKAMURA Osamu

⑥ Classroom at NUNAGAWA Campus

Blueprint

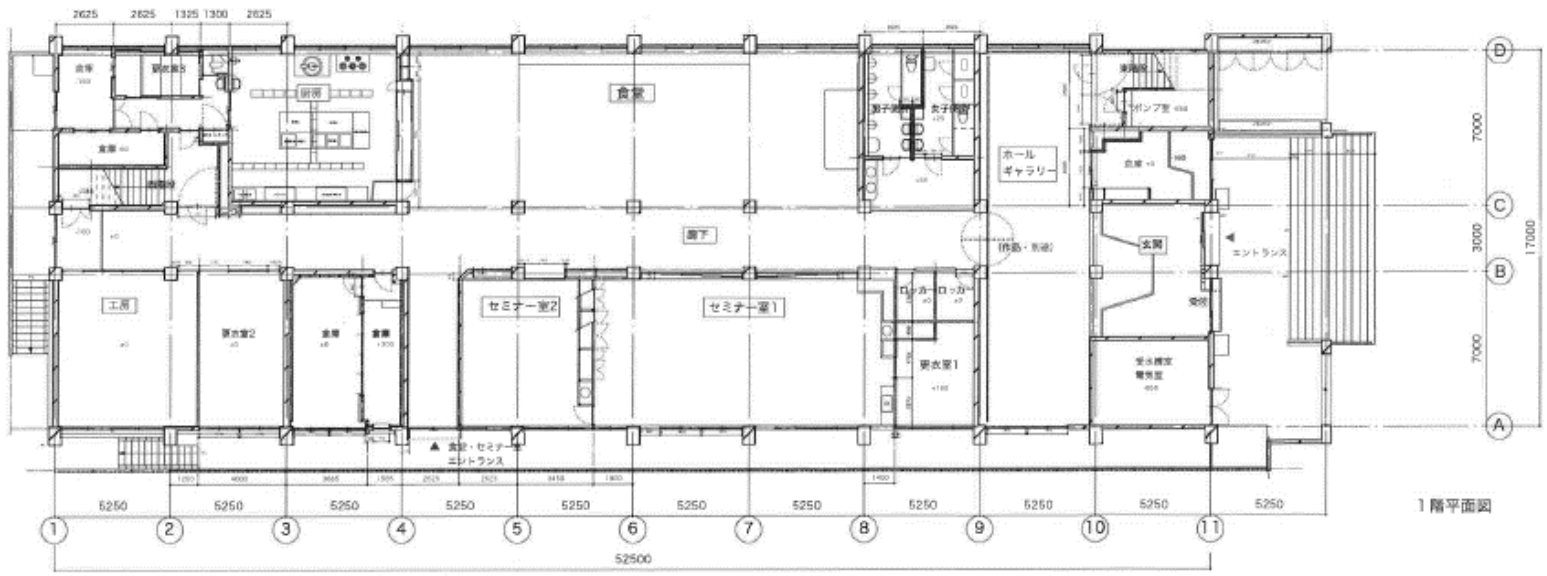
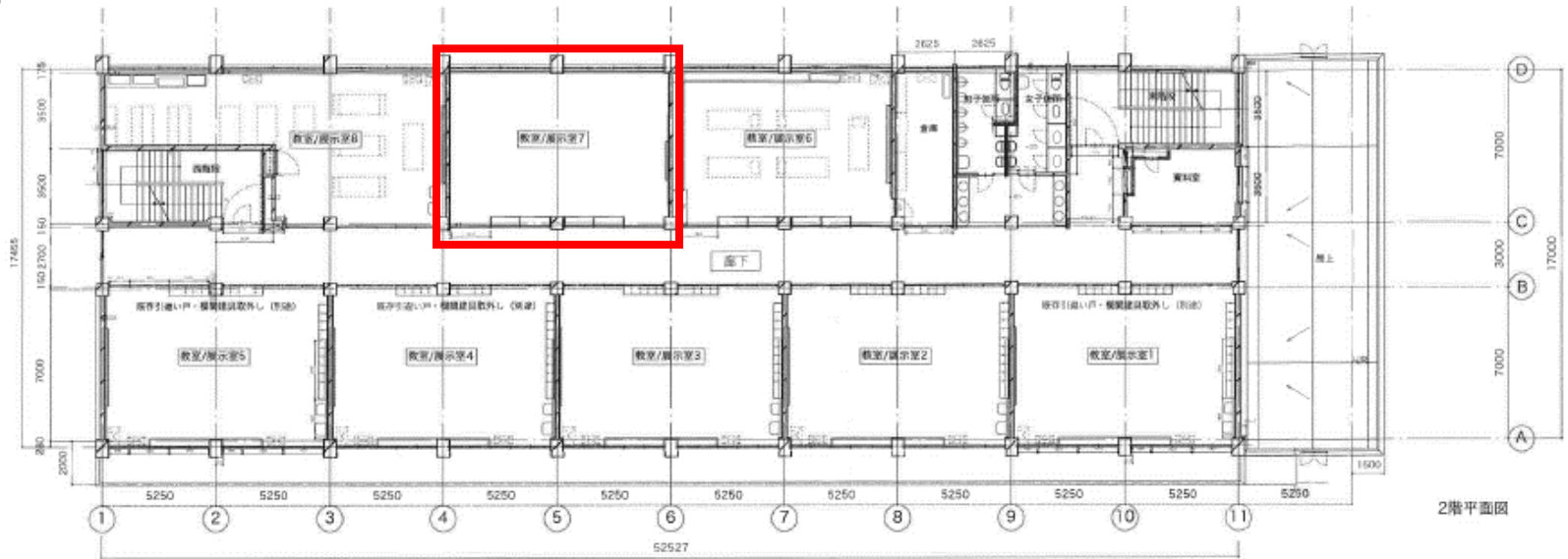

NUNAGAWA Campus is a renovation of the former Nunagawa Elementary School which was opened as a school for people from different regions, generations and backgrounds. It is aspire to be a place for each person to discover what they are good at, such as from food, life, play and dance. It hosts the collections of artworks by Chinese and Russian artists while being a base for an on-going creative activity by Nihon University College of Art as well as a female football team, FC Echigo-Tsumari, bringing a lively scene with local people.

NUNAGAWA Campus is a facility which keeps mostly school-like characteristics without having undergone major renovation and we welcome proposals of artworks occupying one of the classrooms in the building.

⑦ Pool at Echigo-Tsumari Kamigo Clove Theatre

Images (25m × 5 Lanes)



Echigo-Tsumari Kamigo Clove Theatre is a renovation of the closed Kamigo Junior High School which has been turned into a base for performing arts, serving as a residence, workshop and theatre for performers. It offers opportunities for creators to produce a piece of work while learning from the region in Satoyama, which is different from a big city. The restaurant run by local residents providing a theatrical experience is popular amongst visitors.

From the back of the school building provides a view of the rough stream of the middle basin of the Shinanogawa River. There stands an unused swimming pool which presents a calm and dream-like platform. We seek for a proposal of a site-specific artwork that takes advantage of the characteristic of this place.